



205/11 Stawell Street North Melbourne VIC

2  2  1 

Discover the epitome of urban living in this instantly appealing residence, ideally situated within walking distance of the soon-to-be-completed Arden Station. Elevated to capture breathtaking treetop views and the vibrant inner-city atmosphere, this home offers a seamless blend of comfort, style, and convenience.

As you step inside, you are greeted by a light-filled single-level space adorned with sleek oak flooring, creating an inviting ambiance throughout. The generous dining zone flows effortlessly into a spacious lounge area, setting the stage for memorable gatherings with friends and family.

The heart of the home is undoubtedly the superb contemporary kitchen, equipped with modern fittings and finishes, where culinary enthusiasts will feel right at home. Whether you're preparing a quick breakfast or hosting a

Price : ESP \$620,000-\$650,000

View : <https://www.jmre.com.au/sale/vic/inner-city/north-melbourne/residential/unit/7981312>



Jmre A Smartre Agency
03 9328 2002

205/11 STAWELL STREET, NORTH MELBOURNE

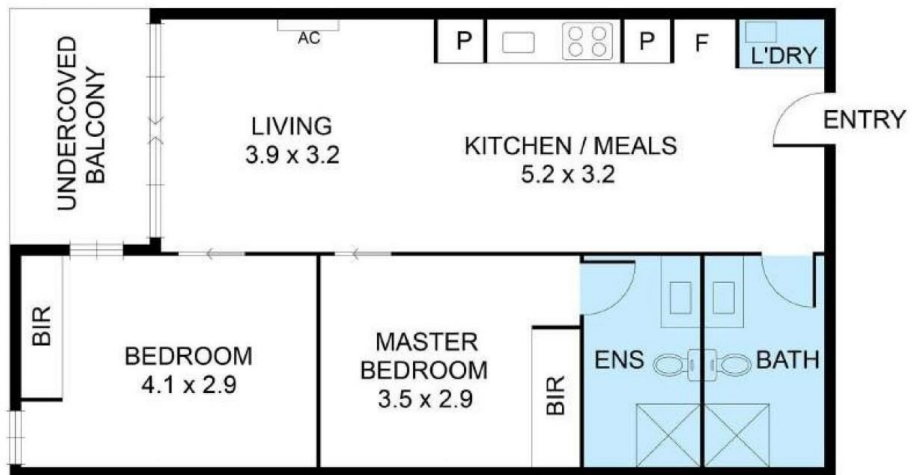

This floor plan and site plan is not to scale; measurements are indicative and in metres, all information in this document has been provided by a third parties, this document should not be relied upon and all interested parties should conduct their own due diligence and rely on their own inquiries.

Produced by JPEG STUDIO