

### 3/30 Chetwynd Street West Melbourne VIC

2 1

With its light-filled interior, delightful outlook over Eades Park and impressive residents' facilities, this sensational first-floor Parkside West apartment makes an ideal city pad. Generous floorplan comprises two double bedrooms (master with BIRs) and stylish central bathroom, stone-top kitchen with induction cooktop and oven, open-plan living/dining area leading out to a sunny front terrace to relax, entertain and enjoy the views. Add to this an additional courtyard (off the master bedroom), split-system heating and cooling, timber floors, European laundry, intercom/secure foyer, plus exclusive access to residents' indoor lap pool, gymnasium and private garden. Also walking distance to Errol Street cafes and Victoria Street trams, Queen Victoria Market, Flagstaff Gardens and the CBD itself.

**Building Size** : 64 sqm  
**View** : <https://www.jmre.com.au/lease/vic/inner-city/west-melbourne/residential/apartment/6365714>



**Mary Sdregas**  
03 9328 2002

# 3/30-44 Chetwynd Street, West Melbourne

Floorplan Dimensions

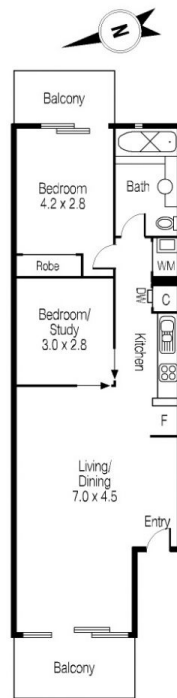

Not To Scale

Every care has been taken to verify the accuracy of details in this brochure. Prospective purchasers are requested to take such action as is necessary to satisfy themselves of any pertinent matters.