

15 Kensington Road Kensington VIC

3 1 1

In a leafy Kensington streetscape, moments from the open spaces of JJ Holland Park, this semi-detached period home is sure to make an immediate impression with its authentic charm, quality enhancements throughout and surprisingly spacious floorplan.

Smartly presented from start to finish, the home's light-filled interior comprises three generous bedrooms with built in robes, updated central bathroom, together with a separate lounge area an open plan updated Kitchen including Stainless Steel appliances. Enhancing its appeal is a full-size laundry, along with timber floorboards throughout, split-system heating/cooling for year-round comfort, plus a wonderfully private rear yard and the added advantage of a front off-street parking space.

Extremely close to scenic parklands, Kensington Recreation Centre, Kensington Village cafés, shops, train stations, buses, Flemington Racecourse, Maribyrnong

Price : \$ 920,000
Land Size : 213 sqm
View : <https://www.jmre.com.au/sale/vic/north/kensington/residential/house/6013526>



John Sdregas
03 9328 2002



The floor plan is not to scale; measurements are indicative and in metres. All features included in this 3D plan are for inspiration purposes only. This is not an exact replica of the property or the position of exterior elements. Plans should not be relied on. Interested parties should make and rely on their own enquiries.

Produced by **DIAKRIT**

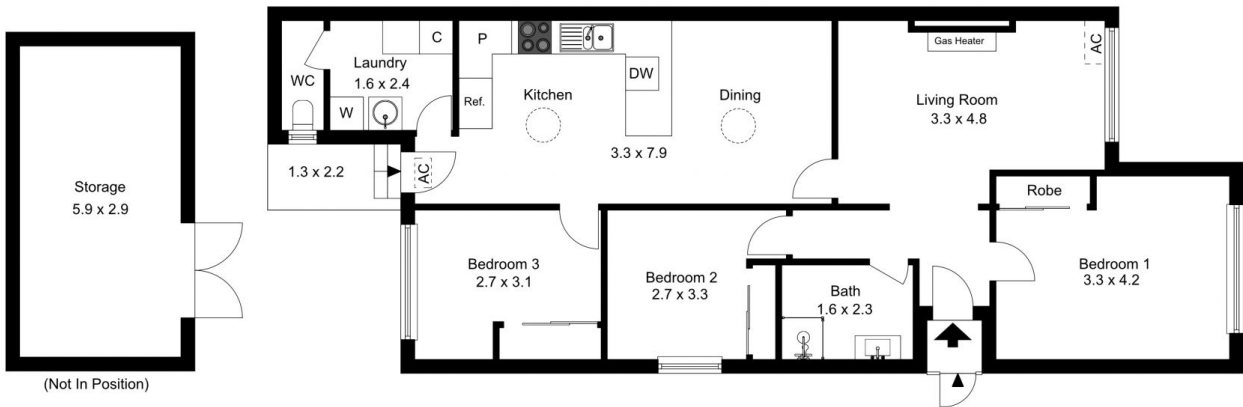

Site Plan



The site plan and floor plan are not to scale; measurements are indicative and in metres. Bushes and trees are placed for illustration purposes. Plans should not be relied on. Interested parties should make and rely on their own enquiries.

Produced by **DIAKRIT**